

300

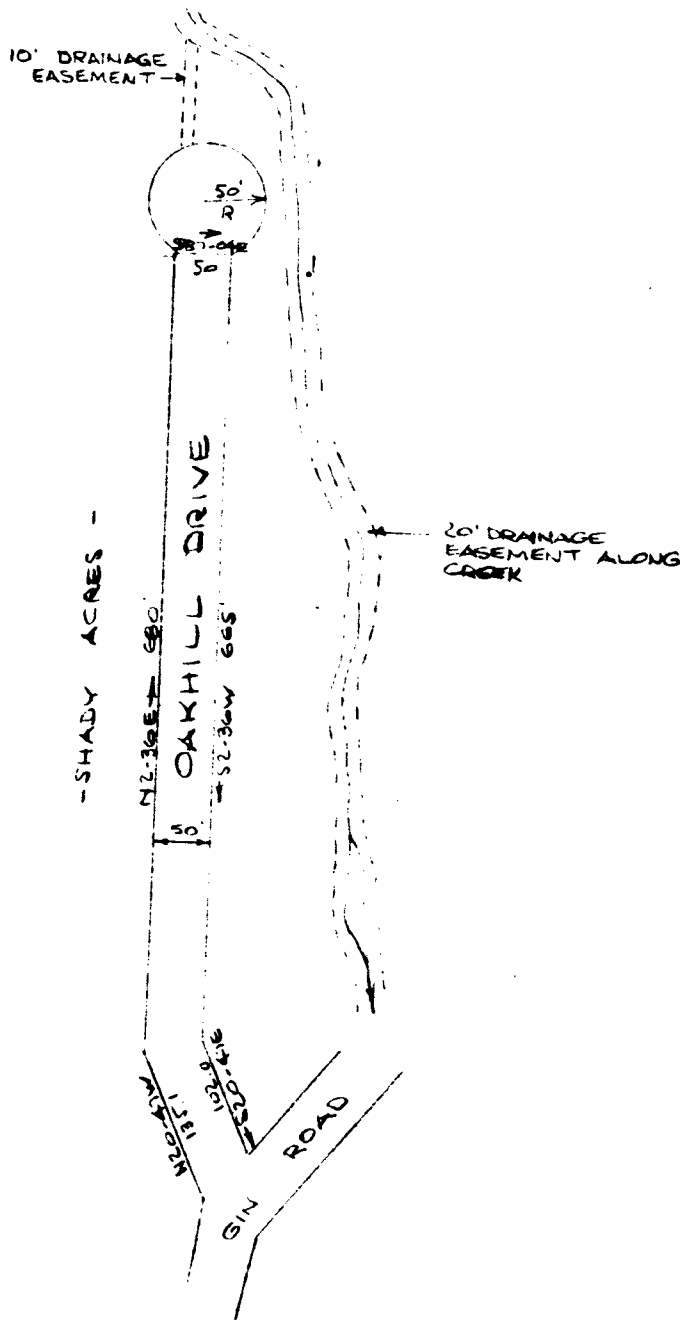

46-157

GREENVILLE CO. S. C.
 APR 13 4 34 PM '71
 OLLIE FARNSWORTH
 R. M. C.

FINAL PLAT OF
 OAKHILL DRIVE
 GREENVILLE CO., S. C.
 SCALE: 1" = 100' 17 DEC 1970

APR 13 1971

23914

THIS PLAT IS NOT A SUBDIVISION
 AS DEFINED BY THE GREENVILLE
 COUNTY SUBDIVISION REGULATIONS.
 4/9/71 *J. B. Johnson*
 Director of Planning
 Greenville County Planning Commission

THIS LAYOUT PREPARED BY CAROLINE
 SURVEYING CO FROM A SURVEY BY WEBB
 SURVEYING & MAPPING CO, MAY, 1962. I
 CERTIFY THAT ALL LINES & DISTANCES
 ARE CORRECT AS SHOWN TO THE BEST
 OF MY KNOWLEDGE.

R. B. Bruce

4/8/71
 approved & accepted by
 all county planners.
John B. Johnson, Jr.
 Co. Supervisor